

THE NEW CdM IS HERE!

CdM Foundation Achieves Major Strategic Plan Milestones



Construction of the new Resource Center

Last Spring, CdM completed a strategic plan, *Preparing for the 21st Century*, which called for five strategic initiatives:

1. Technology
2. Staff development
3. 21st century curriculum
4. Interest-specific academies
5. Collaborative environment

We have worked hard this summer and think you will be impressed with our results. Here are the improvements in the five strategic areas that will be available to your student this fall:

1. TECHNOLOGY

- New tech-oriented Resource Center
- 2 new wireless Internet Cafés
- New technology packages in 25 classrooms
- New Student Technology Center
- New World Language Center

New Technology-Oriented Resource Center

We refurbished our 1960's library and transformed it into a 21st century Resource Center. This new center is designed to provide CdM students with an inviting learning environment and the information technology they need to be successful in today's competitive world.

The new Resource Center opens this fall and includes **20 new student computers**, a **video streaming** presentation system, **scanners**, **content-controlled wireless internet access**, subscriptions to **research data bases**, and all new very **cool furniture**.

Continued on page 2

INSIDE:

	Pages
More on the NEW CdM	2 & 3
Counseling at CdM	4
School nurse	5
Community service coordinator	5
Class of 2006 college acceptances & matriculations	6 & 7
College counseling at CdM	8
CdM Foundation board of directors	9
Neptune's Ball	9
Where your dollars go	10
Foundation investments	11
CdM Foundation donors	12-13
Technology donors	13
Fundraising at CdM	14
How much to donate	15
To donate or to pledge	15
2006-07 donation pledge form	15
Message from CdM administration & fundraising organizations	16

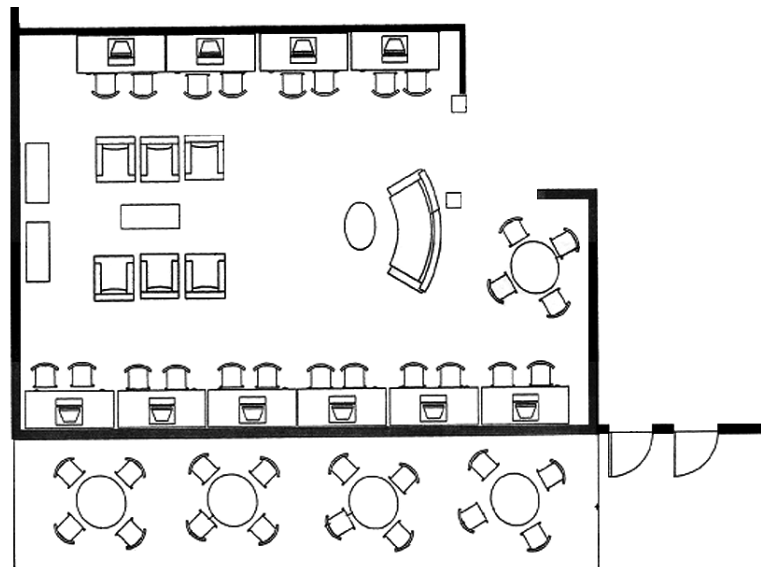

Diagram of the new Resource Center and adjacent Internet Cafe

Two New Internet Cafés

In the fall of 2006, CdM students will be able to study and do independent research at our two new Internet Cafés. These high tech study environments include **content-controlled wireless Internet** and great **new furnishings**. The two new Internet Cafés are located just outside the Resource Center and outside the Career Center. Students will be able to bring personal laptops to school and connect to the Internet just as they would do in college or in a work environment.

Thank You to All Who Have Made the NEW CdM Possible

The Technology vision for CdM has become a reality due to a lot of hard work and a partnership between CdM Administration, Staff, Foundation and NMUSD Information Technology and Education Technology departments. A special thank you to:

Fal Asrani, CdMHS Principal

Brian Corrigan, CdM parent and Foundation Board member

Bruce Cox, Mesaure A Site Contractor

Cindy Dillion, CdM parent and Foundation Chairperson

Alan Enguard, NMUSD Information Technology Director

Chuck Fay, CdM parent and Foundation Board member

Carol Gaetano, CdM parent and Interior Designer

John Gormly, CdM parent and Foundation Board member

Steve Glycer, NMUSD Ed Tech Director

Chris Kittrell, CdM parent and Interior Designer

Lainie McGann, NMUSD Educational Technology Coordinator

Guy Olguin, CdM Middle School Principal

Terry Stephan, NMUSD Technology Support Supervisor

Brian Tulley, CdM Science Teacher and Technology Site Coordinator

All of our generous Technology Donors

room **technology packages in 25 classrooms**. These technology packages include computer-integrated projection systems and Smart Airliner wireless pads. Teachers who complete their Level II Technology certification also get new laptop computers.

New Student Technology Center

We replaced one of our very old, very slow and very crowded computer labs with a new Student Technology Center. Many parents have heard complaints about our old labs being too slow to be useful and too crowded to get a seat. Our new Student Technology Center will include **40 new computers, video streaming and computer-integrated projection**, a **scanner** and much faster internet connections. The Student Technology Center will be used to teach using One-to-One instructional methods (one computer for every student) as well as for research.

New World Language Lab

Taking a minimum of two foreign language classes is required at CdM and speaking a foreign language is considered an essential 21st century skill. The UC's and more competitive colleges recommend four years of high school foreign language.

This fall we are refurbishing our old, tired and barely audible language lab with a high-tech World Language Lab. **Forty new computers**, installed with **language-specific software** and **head phones** will provide a venue for both individual language practice and classroom instruction. **Computer-integrated projectors, Smart Airliner Wireless pads, remote mouse/pointers** and electric screens provide a well-integrated presentation package for group instruction. Finally, the new World Language lab will be stocked with **16 video cameras** available for student check-out.

New Classroom Technology

Our two to three year goal is to replace classroom technology in all CdM classrooms. This fall we will have installed new class-

Did you know that NMUSD has no budget for technology? All computers and related technology must be bought with private funding, grants and site funding.

**Technology Plan Phase II
We Can Proceed Only When Additional Funding is Raised**

To complete Phase II of our technology plan we need to raise more funds. We want to provide new **classroom technology for every CdM classroom**. This year we have funded 25 class-

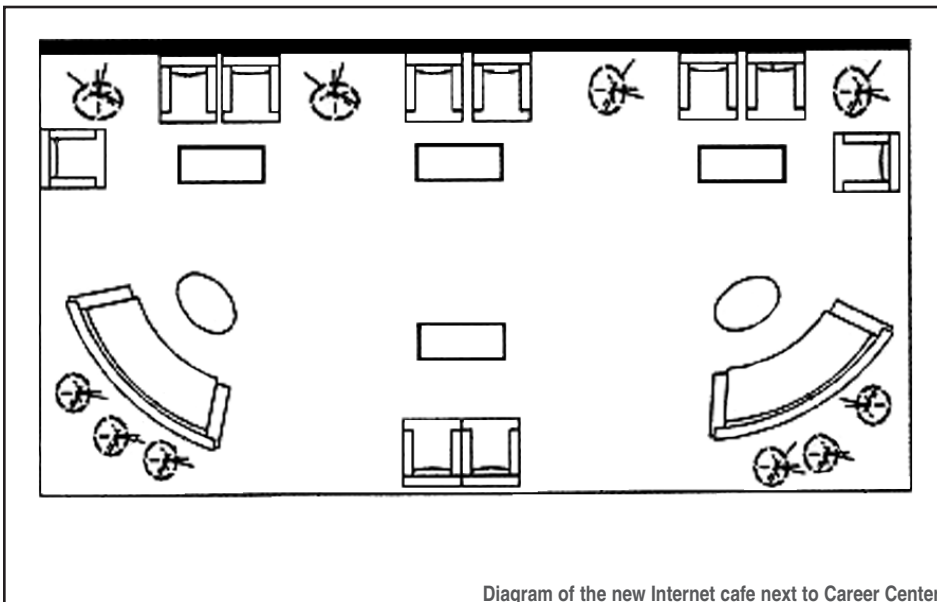
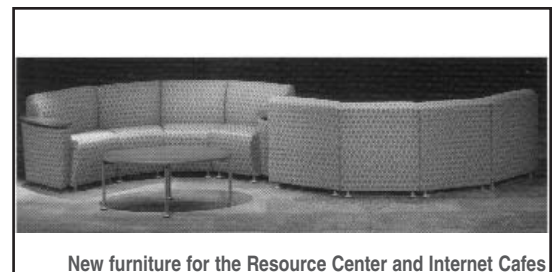

Diagram of the new Internet cafe next to Career Center



New furniture for the Resource Center and Internet Cafes



New furniture for the Resource Center and Internet Cafes

rooms. We have 55 more classrooms to go. Secondly, we want to refurbish our old PC lab and create a **second Student Technology Center**. These Student Centers are in tremendous demand. One center falls far short of student needs.

Help us finish our technology plan. Send in your donation today so we can provide your children with the tools they need for tomorrow's success.

2. STAFF DEVELOPMENT

CdM's strategic plan called for extensive staff training, including:

- Technology
- Information literacy
- Instructional practices and techniques
- 21st century skills
- Honors AP curriculum
- Academy-specific subjects
- IB curriculum

CdM Foundation Supports Staff Development

The CdM Foundation has investments in place to support staff development:

The Foundation and the PTA **co-funded CdM's annual fall staff development retreat**. This year, more than 90% of the certified staff attended this 2.5 day team-building program. This is a highly popular staff program and all teachers attend without pay.

Additionally, the Foundation has worked closely with the NMUSD Technology department to place our new classroom technology in the hands of the teachers who are most qualified to use it. The district has developed two levels of technology and information literacy training. The first level of training instructs teachers how to use the new technology at fairly sophisticated levels. The second level of certification provides new methods of teaching using technology. **CdM teachers must pass Level I training to qualify for new classroom presentation packages and Level II training to receive a classroom laptop computer.**

Our new Student Technology Center and Resource Center will provide zero-period venues for staff development.

3. EXPANDED CURRICULUM

CdM has aggressive plans to expand curriculum and integrate technology, information literacy and other 21st century skills across all courses. Some of the new courses to be added include:

2006-07

- 7 New Honors courses
- American Sign Language
- Online Health
- AP Psychology
- 2 College-Credit evening classes

2007-08

- Additional Honors courses
- Mandarin Chinese
- Additional Online courses
- Career-Oriented courses
- Performing Arts & Multi Media Academy courses

2008-09

- International Baccalaureate Academy courses

The CdM Foundation supports these new courses by providing technology that is imbedded in the curriculum.

4. INTEREST-SPECIFIC ACADEMIES

Our first interest-specific academy, **Performing Arts and Multimedia (PAMA)** is still in the planning stages. This program will integrate core curriculum into a variety of arts classes, including: graphic arts, animation, drama & stage craft, electronic music production, film & video production, publicity & journalism, and dance.

Additional potential academies will be surveyed for interest including: Entrepreneurship, Law, Medicine and Engineering.

5. COLLABORATIVE ENVIRONMENT

CdM's strategic objective is to further evolve our collaborative educational community to provide more resources and opportunities for our students. The goal is to:

Work with:

- Parents
- Community
- Businesses
- Government
- Local colleges

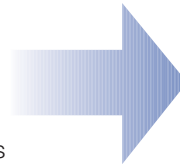

To provide:

- Funding
- Grants
- Mentoring
- Internships
- Higher learning opportunities

The Foundation has taken two important steps to advance our collaborative relationships:

Grant Writing Position

Karin Krogius, a CdM parent, has joined the Foundation Board and is focusing her efforts on a new position: **Foundation Grant Writer**. Over the summer she wrote our first grant and is targeting another dozen grant opportunities that fit with our strategic objectives. Grants will provide another source of funds to further CdM's strategic plan.

Expanded Responsibilities for Denise Weiland, our Community Service Coordinator

For many years the CdM Foundation has provided supplemental stipends to expand our Community Service program. This year we have increased that stipend and added **student internship** coordination to the Community Service job description.



I support CdM's Tech Plan and the Foundation. It is important to do. California public schools get very little money from the state. Your donation really funds your own child's education.

Kathleen Chaix, CdM parent and new Girl's Lacrosse Coach

"What CdM teachers love about our Tech plan is it gives us the resources we need to develop meaningful, real world curriculum for every child, every day.

Brian Tulley, Middle School Science teacher and CdM Technology Site Coordinator



CdM Counseling and Student Support Services

A major part of the Foundation's annual budget goes to provide our students with enhanced support services, including **Guidance Counselors**, a **College Counselor**, additional **School Nurse** hours, additional programs from our **Community Service Coordinator** and a **Senior Project Coordinator**.

COUNSELING AT CdM

Providing a quality counseling department has been an ongoing priority for the CdM Foundation for many years. In California, counseling positions have been slashed to the bone and even

eliminated in some districts. The **average student-to-counselor ratio in California is 966:1**, compared to the **U.S. average of 488:1** (*American School Counselor Association — June, 2006*). This year, CdM's ratio without Foundation supplementation would be 727:1. For 2006-07, the **Foundation pays salaries that effectively reduce our student to counselor ratio to 363:1**.

These extra counseling positions provide our students with the direction they need to select courses, meet requirements, target good college fits, complete college applications, and overcome personal issues and special needs. In short, the CdM counseling department is there to help our students succeed and maximize their opportunities.

CdM Counseling Department With Foundation Funding 363:1 ratio



Counselors from left: Marianne Scott, Sarah Belski, Lindsay Thompson, George Gutierrez, Kathy Hath, Kelly Lipps.

My daughter came to CdM from a well respected private school and I was amazed to find out that the quality of CdM's counseling was so much better and that it was more personal than I would have ever imagined possible in a school with so many students.

Victoria Vesna, PhD,
UCLA Department of
Design | Media Arts

CdM Counseling Department Without Foundation Funding 727:1 ratio



My son had attended private school up until he started school at CdM in the 11th grade. He moved from my home to reside with his father and Mrs. Hath has been my link to information regarding my son's academics. She has been timely in her e-mail responses, encouraging, and a blessing. Words cannot express my gratefulness. Thanks again.

Alicia Morris,
CdM Parent

SCHOOL NURSE

Annette Dunn

Annette Dunn, our school nurse, has duties that go far beyond taking temperatures and applying Band-Aids. The Foundation provides funding to **double her district-paid hours**. As a result we have a nurse on campus five days a week and Annette has **expanded her role from basic health care to “health education.”** She provides seminars and one-on-one counseling for important teen topics such as stress, drugs & alcohol, eating disorders, sex education and other at-risk behavior. She also spearheaded the very successful, optional on-campus drug-testing program to CdM.

School Nurse With Foundation Funding



School Nurse, Without Foundation Contribution



COMMUNITY SERVICE COORDINATOR

Denise Weiland

To support the development of new programs for our students at CDMHS, the Foundation is increasing our supplemental stipend for Denise Weiland, our Community Service Program Specialist. Denise will coordinate **student internship opportunities** and evolve our **Community Service** program into a **Service Learning** program, linking community service opportunities to curriculum and education standards. Denise will also develop a **new student mentor/internship program** and will serve as one of the advisors for the Human Relations Student Council.

Community Service Coordinator With Foundation Stipend



Community Service Coordinator Without Foundation Stipend



Class of 2006 College Acceptances and Matriculations

UC's

Berkeley, 17A, 9M
 Davis, 14A, 3M
 Irvine, 30A, 12M
 UCLA, 20A, 6M
 Merced, 5A, 0M
 Riverside, 8A, 1M
 San Diego, 21A, 2M
 Santa Barbara, 32A, 13M
 Santa Cruz, 18A, 8M

KEY A = Acceptances
 M = Matriculations

Cal States

Cal Poly Pomona, 1A, 0M
 Cal Poly SLO, 3A, 0M
 Channel Islands, 1A, 1M
 Chico, 1A, 0M
 Dominguez Hills, 1A, 0M
 Fullerton, 9A, 2M
 Humboldt, 1A, 1M
 Long Beach, 12A, 2M
 Los Angeles, 1A, 0M
 Monterey Bay, 2A, 0M
 Northridge, 1A, 0M
 San Diego, 12A, 2M
 San Francisco, 12A, 1M
 San Jose, 1A, 1M
 San Marcos, 3A, 0M
 Sonoma, 1A, 0M

Other California

Azusa Pacific Univ., 7A, 3M
 Biola, 1A, 0M
 Brooks Institute of
 Photography, 1A, 0M
 Chapman Univ., 11A, 4M
 Claremont McKenna College, 1A, 1M
 Fashion Institute of Design & Merch.
 Irvine, 1A, 1M
 Los Angeles, 1A, 1M
 Fullerton College, 2A, 1M
 Harvey Mudd College, 1A, 1M
 Irvine Valley College, 4A, 3M
 Loyola Marymount, 23A, 9M
 Marymount College, 4A, 3M
 Menlo College, 1A, 0M
 Occidental College, 2A, 0M
 Orange Coast College, 16A, 11M
 Univ. of the Pacific, 3A, 0M
 Paul Mitchell The School, 1A, 1M
 Pepperdine, 2A, 1M
 Point Loma Nazarene, 5A, 0M
 Pomona College, 1A, 1M
 Univ. of Redlands, 2A, 1M
 St. Mary's College, 2A, 1M
 Univ. of San Diego, 8A, 4M
 San Diego Mesa College, 1A, 1M
 Univ. of San Francisco, 3A, 0M
 Santa Barbara City College, 4A, 3M
 Santa Clara Univ., 5A, 0M
 Santa Monica College, 2A, 2M
 Santiago Canyon College, 1A, 1M
 Scripps College, 1A, 0M
 Stanford, 3A, 3M
 USC, 22A, 15M
 Vanguard, 5A, 5M
 Westmont College, 4A, 3M
 Whittier College, 1A, 1M

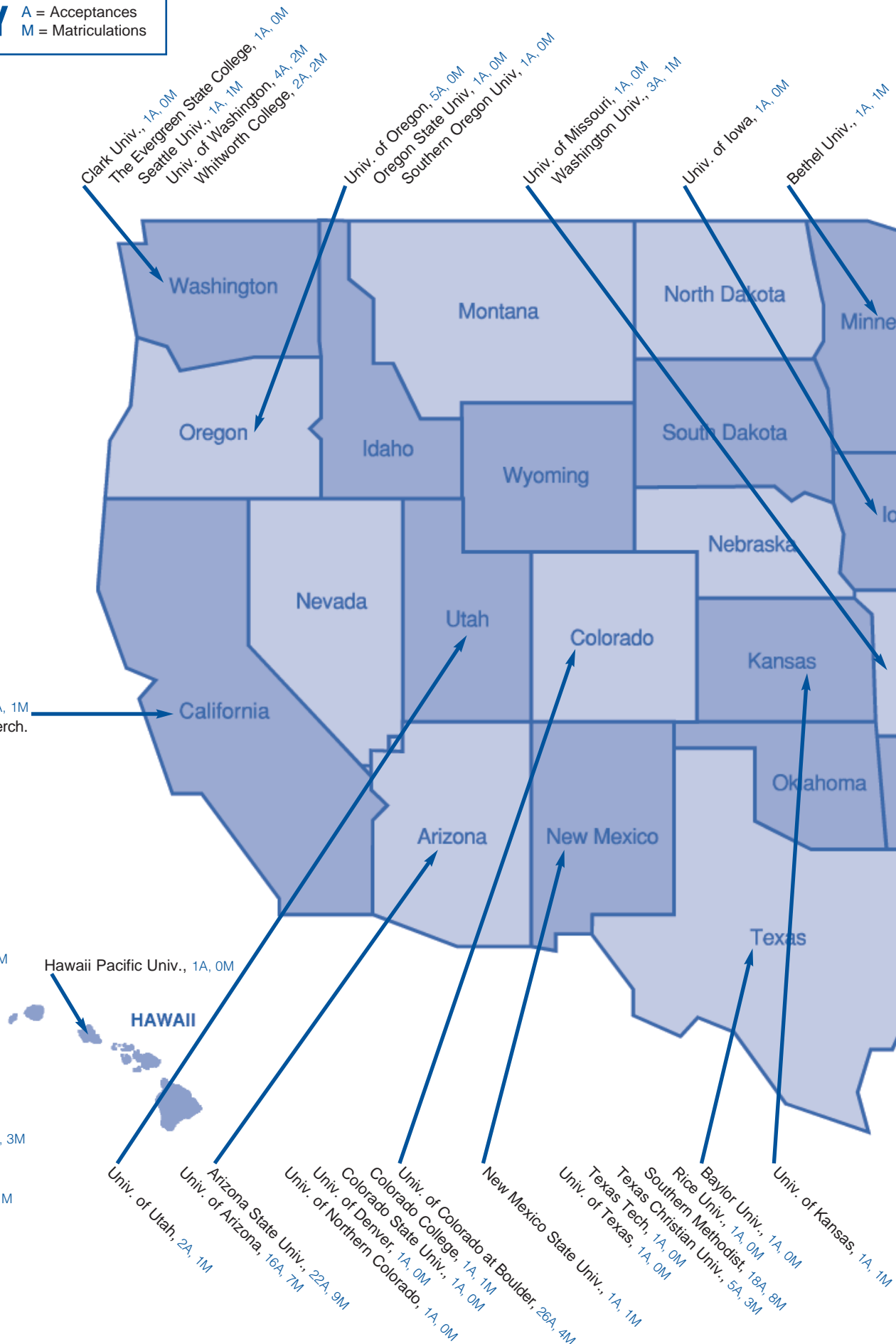

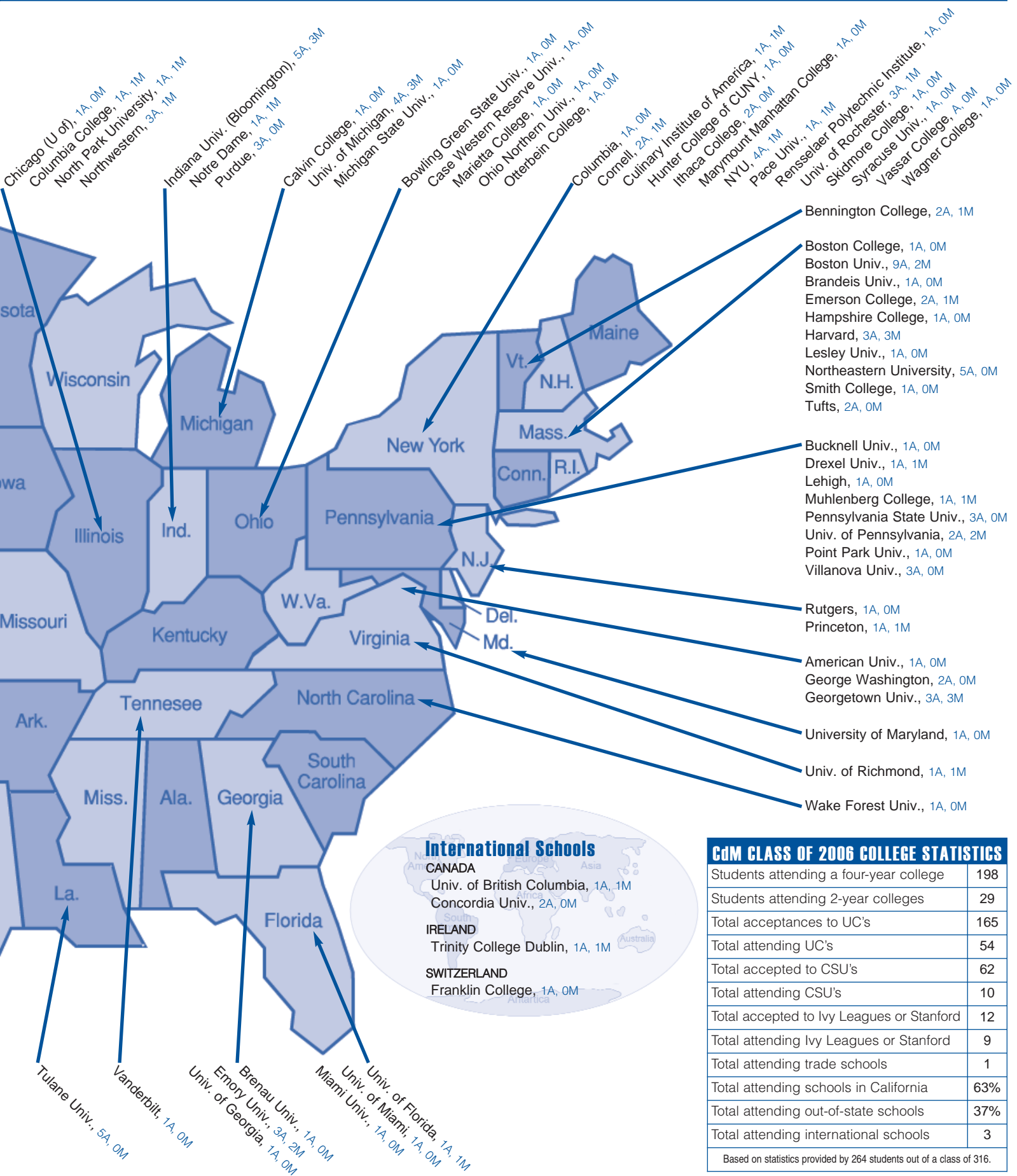

CDM CLASS OF 2006 COLLEGE STATISTICS	
Students attending a four-year college	198
Students attending 2-year colleges	29
Total acceptances to UC's	165
Total attending UC's	54
Total accepted to CSU's	62
Total attending CSU's	10
Total accepted to Ivy Leagues or Stanford	12
Total attending Ivy Leagues or Stanford	9
Total attending trade schools	1
Total attending schools in California	63%
Total attending out-of-state schools	37%
Total attending international schools	3

Based on statistics provided by 264 students out of a class of 316.

Congratulations Class of 2006!

Students today face a much more complex college application process and a far more competitive college market than their parents did. To help facilitate the college application process and to insure that each and every CdM student finds the college that is right for him, the CdM Foundation funds an **on-site College Guidance Counselor**. This is highly unusual for a public school, but the CdM Foundation believes an on-site college counselor is essential to our students' post-high school success.

Last year, Marianne Scott coordinated a number of important events and programs for CdM students, including:

- Freshman, Sophomore and Junior **parent nights**.
- Over **30 campus visits** to CdM by college representatives.
- **"How To" workshops** for filling out **on-line applications**.
- Lunchtime **college essay workshops**.
- **In-class college essay lessons** for all juniors, including the 5 most important rules.
- Junior and Senior **Naviance training** and Naviance application updates.
- Saturday **Practice Test Day** for students to practice taking the PSAT, SAT, ACT and subject tests.
- **Financial Aid night**.
- **PSAT Scores night** – How to use your PSAT score.
- **College Search Night** – How to find the right match.
- **Monthly Spinnaker articles** and grade-by-grade college preparation "To Do" lists.
- Maintains **College 411** website.

COLLEGE 411 WEBSITE

Access the College 411 website by first going to:

cdmFoundation.org



and then clicking on **College 411**.

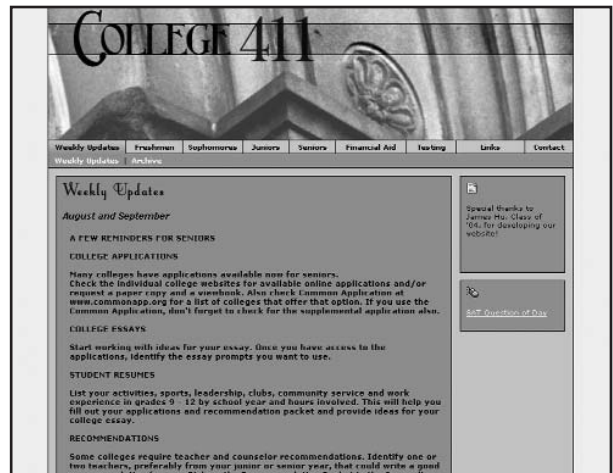

Mrs. Scott makes students feel welcome in her office, which tremendously eases the stress of the college application process. This past year she met with every junior English class to explain the common mistakes and conventions while writing the college admission essay. Without her support, I am certain that my college application experience at Corona del Mar would not be as enjoyable or successful.

Allison Gruber, CdM Senior



Marianne Scott and Cole Trider (class of 2006)

Finding the right college is about finding the right match. I really enjoy working with the students at Corona del Mar and helping them maximize their opportunities to make the right match.

Marianne Scott,
CdM College Guidance Counselor

Mrs. Scott provides excellence in the college application process and is a true asset at Corona del Mar.

Cole Trider,
Class of 2006

2006-2007 C&M FOUNDATION BOARD MEMBERS

CINDY DILLION
Chairperson

SHERRY ABBOTT
Donor Events/Press Liaison

CHRIS BALDEN
7th Grade Campaign

MONICA BURKE
Member at Large

JEFF CARLILE
8th Grade Campaign

BRIAN CORRIGAN
Corporate Campaign

SUE COX
Back-to-School Night/Donor Recognition

DIANE DALES
Membership

GREG DILLION
Corporate Campaign

CHUCK FAY
Technology Liaison

JOHN GORMLY
Resource Center Project

CHIP GREENE
Webmaster

TERRY HACKETT
Emeritus

DIANE KELIGIAN
Member at Large

RAY KENNEDY
Corporate Campaign

KAREN KROGIUS
Grant Writing

JOE KRUM
7th Grade Campaign

KEN LACROIX
7th Grade Campaign/Infrastructure Project

KEN LINDT
Corporate & Phone Campaign/Database

JIM LUDLOW
Corporate Campaign/Neptune's Ball

JIM MCKENNON
Special Events

DON MORROW
Corporate Campaign/Private School Grads

KIM PAWELL
Strategic Plan, Newsletters & Brochures

KIM PRICKETT
Emeritus

KATE ROLLINS
Emeritus

JOHN RYCHEL
Treasurer

MAREA SUOZZI
Emeritus

NADINE TURNER
Communications

ANDY WALLACH
7th Grade Campaign

JIM WATSON
Corporate Campaign

MARK WILLIAMS
Member at Large

ARNE YOUNGMAN
7th Grade Campaign



Neptune's Ball will be held on February 3, 2007. Don't miss this fun-filled night of mingling with parents and staff, fabulous auction items, dinner and dancing. Enjoy a wonderful evening AND do something great for your children's school. Last year \$104,000 was raised for Technology!

Do you enjoy planning parties? We are looking for a few good people to help us plan this year's Neptune's Ball. Interested? Call Jim McKennon at (949) 644-5757.

Where Your Dollars Go

This year, CdM Foundation has an aggressive investment plan. We plan to invest nearly \$1,000,000 in CdM this year, and we have already made a healthy start on our plan this summer. This year, our big investment is in Technology.

WE NEED TO RAISE \$600,000

This year's **\$930,000 investment plan** is aggressive, but we have done it before. In 1995, CdM Foundation's inaugural year, nearly \$1.5 million was invested, with a large portion going to technology. Technology dates quickly, **10 years have passed, and we are long overdue for another major investment in technology.**

The good news is we have reserved Neptune's Ball profits precisely for the purpose of investing in technology. Therefore, **we started our Technology plan with over \$300,000**, or just about half of what we need.

To fund the Foundation's ongoing programs (counselors, school nurse, etc.) and new technology investments, **we need to raise \$600,000 this year.** To achieve this goal we need all families to contribute, and we need families to contribute more generously than they would in a year without large technology investments.

We are asking everyone to donate \$1,500 to \$2,000 this year: \$1,000 to support our ongoing programs, and another \$500 to \$1,000 to enable us to complete our technology plan.



Does the Foundation help the Science Department? YESSSSSSS!!! Students benefit from multiple resources that would be out of the question with our normal state budget. The Foundation has provided our science program with digital whiteboards, electronic motion detection sensor, telescopes, computer-integrated projectors, microscopes and more. Thank you Corona del Mar Foundation!!!!

Peter Selby
Science Chair

Thank you Foundation for continuing to support the English Department Grading Day. The days spent grading student work greatly impact student writing fluency; as a teacher I feel empowered by the ability to focus on writing and moving students toward more sophisticated methods of expression.

Debbie Sidler
English Department Chair



2005-2006

\$313,000 Investment Budget

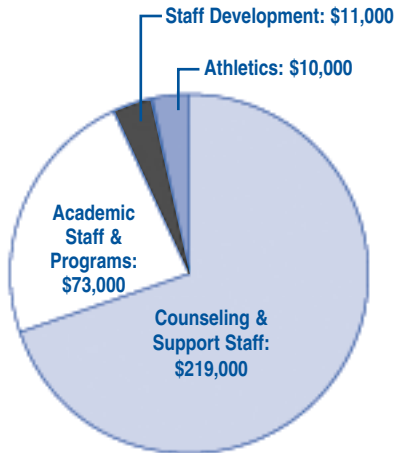

2006-2007

\$930,000 Investment Budget

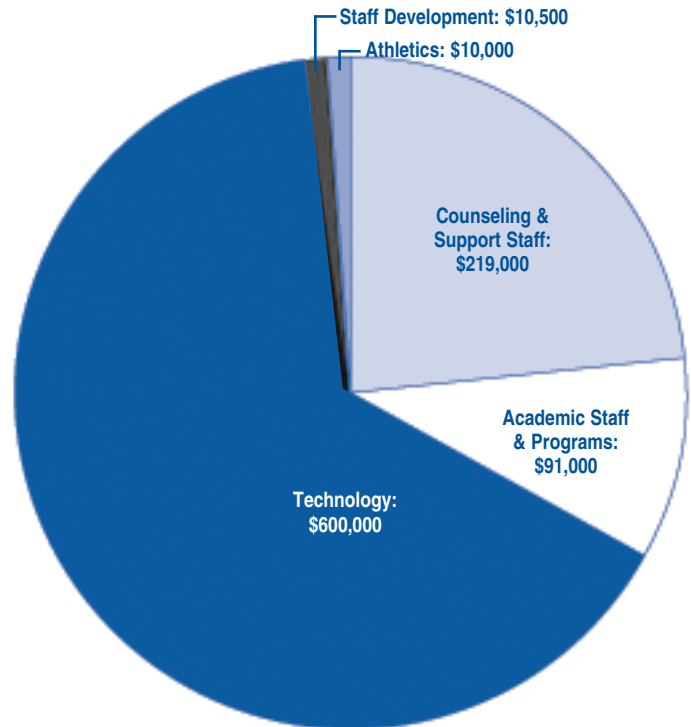

2006 – 2007 INVESTMENTS

Technology

165 computers	World language software
Smart Airline wireless pads	Security cameras
Computer-linked projectors	Wireless Internet connections
Electric screens	Remote mouse/pointers
3 Video streaming stations	Printers
Microphones and speakers	Printer toner
Online database subscriptions	Scanners
Adobe Photoshop & Premier Elements software license	40 headphones
	16 video cameras

Staff and Programs

Guidance counselor	Science teacher's assistant
Counseling technician	After-school science clinic
College counselor	After-school math clinic
Community service coordinator (33%)	SAT prep clinic
School nurse (50%)	English grading days
On-site computer technician	Music consultant/TA's
Senior project coordinator	Staff development retreat (50%)
	Athletic trainer (33%)

From left: Brian Tulley, Fal Asrani and Guy Olguin



CdM's strategic plan incorporates new technology, curriculum and staff development to provide all of our students with powerful tools they need to compete in the 21st century. Please support this vital educational endeavor.

Fal Asrani
CdM HS Principal

CdM's technology plan will provide our middle school students with skills that will serve them throughout their career at CdM and beyond. Please contribute to CdM's technology plan today, and your middle school student will reap the benefits for the next six years.

Guy Olguin
CdM MS Principal

NEARLY \$6 MILLION INVESTED IN CdM

Over the past 10 years the CdM Foundation has invested nearly **\$6 million dollars** in **facilities, technology, staff, academic programs, equipment, software and reference materials**. Some investments were funded exclusively by the CdM Foundation and others were co-funded with the PTA, Boosters and other parent organizations. **None of these investments had district or state budgets available.** If it were not for the CdM Foundation and participating parent funding groups, these investments would simply not have been made and CdM students would have gone without their benefit.

Facilities

Chemistry dry lab	Bathroom renovations
Science dry lab furniture and equipment	Community service & ROP facility
450 new lockers	Roof repairs
Repainted entire campus exterior	Parking lot repairs
Resurfaced parking lots	Irrigation improvements
Campus maintenance & landscaping	Gym renovations
Campus security	All-weather track
Renovated Little Theater	Resurfaced tennis courts
	Football weight room
	Baseball field renovation

Technology

Mac & PC labs	Digital arts printer
Language lab	Software upgrades, maintenance & licensing
Digital print shop for arts lab	Computer-integrated projector systems for classrooms
Middle School Tech lab	Library computers and CD tower
Network wiring of entire school	Journalism technology
Workstations for every teacher	

Programs

After school science, writing and math clinics	7th & 10th grade Challenge Days
Fall staff training retreat	Teacher computer training
Peer Assistance Leadership (PAL) program	

Staff

Guidance counselors	School nurse (50%)
Guidance counselor technician	Librarian
College counselor	Middle school activities director
Community service coordinator stipend	Music consultants
Teachers' assistants	Onsite computer technician
English grading day substitute	Athletic trainer (33%)

Equipment & Reference Material

Supplemental funds for text books	Music instruments
400 student desks	College reference materials
Whiteboards for all classrooms	Wrestling mats
Science lab equipment	Grants to football, music, water polo, tennis and Special Ed.

2005-2006 CdM Foundation Donors

Thank you to the **306** generous families and corporations who contributed a combined **\$409,000** to the CdM Foundation last year.

2005-2006 Donor Board Recognition

Anonymous

Alec & Sherry Abbott
Nasar & Bang-Co Aboubakare
Rooven & Denise Akiba
Mike & Julie Alvarado
Rich & Kris Anderson
Dave & Robyn Ashton
Ken & Denise Battram
Bruce & Diane Bearer
Gary & Linda Bennett
Raymond & Lori Berg
Phil & Diana Berry
Wayne & Roz Berry
Alan & Lesley Beyer
Larry & Claire Bianchi
Robert & Mei Bickner
Jeff & Devon Bloom
John & Tracy Bodovitz
Steven Brombal Family
Harvey & Nancy Brown
Tim Buckley
Tiet & Linh Bui
Sean & Monica Burke
Brian Burke
Michael Bush & Kathleen Chaix
Jeff & Carol Carlile
Karl & Martha Carrier
Doug & Joyce Cassel
Andy & Grace Chen
Cynthia Childs
Chulwon & Sooryon Cho
Brad & Marilyn Christian
Gene & Cynthia Clark
Bill & Amy Claster
Joe & Brenda Colgate
Allan & Diane Colvin
Conger Family
Matt & Betsy Cooper
Brian & Kate Corrigan
Paul & Stephanie Couchot
Ken & Pam Coulter
Craig & Sue Cox
Mark & Linda Craig
Gary & Carol Crane
Gary & Nancy Cremo
John & Kingsley Croul
John & Alicia Cummings
Brant & Nancy Dahlfors
Ron & Diane Dales
Rick & Carol Dalton
The Davis Family
Melissa Davis
Robert & Anne Davis
John & Robin De Lotell
Chris & Sheri Dialynas

Lee & Kathy Dick
Greg & Cindy Dillion
Dwight & Ruth Doering
John & Celina Doka
Marito & Amy Domingo
Tim & Jean Donnelly
Michael & Jill Draffin
Tom & Deanne Duddy
Cindy Dupuie
George & Mary Eadington
Mark & Marcia Engstrom
Jerry & Missy Entin
Randy Erickson & Kristy Maurer
Bill & Kathy Fallon
Eric & Aline Farmer
Chuck & Alison Fay
John & Judy Feeley
Craig Fisher
Mark & Susan Fleming
Chris & Malin Fletcher
Dan & Dory Ford
Scott & Margie Forman
Harold & Rosalind Fox
Brian & Mimi Freeman
Mark & Gale Friedman
Chuck Fry
Mark & Julie Fujita
Rob & Melanie Funsten
Francisco Gallardo
Jeff & Lori Gardner
Doug & Julie Garn
Andrew Gerken
Dev & Prema Ghose
Jeff & Lisa Giger
William Gillespie Foundation
Jeffrey & Donna Gingold
Ira & Rita Goldberg
Gunnar & Stephanie Gooding
Richard & Cecilia Goodman
The Goodmanson Family
Robert & Lisa Gorab
Todd & Anne Gordinier
Dennis & Terri Gordon
John & Bridgit Gormly
Robert & Angela Gratzinger
Phillip & Jada Greenberg
Chip & Nancy Greene
Kirby & Tamra Greenlee
Fred & Rose Greensite
Robert & Sally Griffith
Evan & Jane Gruber
Mustafa Gunay
The Gushue Family
Rob & Debbie Guthrie
Matt & Tracey Hagemann
Bill & Holly Halford
Bill & Becky Halladay
The Gregg Haly Family
Greg & Teri Hardke
Mark & Lisa Harryman
John & Mary Jeanne Hawes
Dan & Kathy Heinfeld
Brian Henderson
Jamie & Gail Henderson

The Hildebrandt Family
Brad & Lisa Hillgren
Gail Hirsch
Peter & Sue Hitch
Chris Ho
Van & Helen Holland
Brian & Debbie Hoppe
Kathy Horton
Jenny Huang
Steve & Carla Hummel
Joe & Mary Ann Huntsman
Edward & Julie Indvik
Jeff & Christy La Barthe
Holly Jarvis
Jeffrey Johnson
Carl & Marty Johnson
Jim & Merrins Jones
Pat & Lisa Jones
Rex & Patrice Jones
Kyle & Cherrill Kawakami
Steven & Dulcie Kawata
Alan & Debra Kaye
David & Diane Keligian
Kathryn Kendall
Ray & Liz Kennedy
Rob & Anne Kent
John & Nancy Kerr
Mehdi & Nooshin Khosh
Paul Kim
Ray & Betsy King
Jerry & JoVonna Kinkade
Mike & Suzette Kirby
Jim & Marilyn Kirby
Jim & Jerrilynn Kline
Miro & Gail Knezevic
Neil & Lisa Knuppel
Michael & Theresa Koontz
Rose Kottke
Kyle & Joi Kring
Michael & Joyce Kurtz
Michael & Lisa Lambert
Stephanie Lamons
Bill & Allisha Lange
James & Terri Lawson
Gary & Carol Legrand
Jim & Marcia Leimkuhler
Corey & Leslie Leyton
Christian & Mette Light
Bob & May Lin
Mike & Michelle Lin
Ken & Annie Lindt
Dan & Betsy Livingston
Warren & Susan Lortie
Sam & Cheryl Lu
Randall & Beth Luce
James & Sandra Ludlow
Peter & Deon Macdonald
Sharon MacDonald Family
Art & Teresa Manni
Bob & Susan Maples
The Marans Family
Robert & Lori March
June Marchigiani
Tim & Patsy Marshall

John & Karen Martin
Brad & Pam Martin
Jon & Elizabeth Martino
Scott Mason & Karin Krogius
Tony & Jennifer Mathews
Kevin & Yvette McCarthy
Thomas & Melissa McCormack
Kurt & Anne McElroy
Jim & Tammy McKennon
Gary & Carolyn McKitterick
Mark Merriman & Heidi Neal
Todd & Erin Meyer
Jeff & Diane Miller
Otis & Karen Mitchell
Minsen & Tramy Mok
Emery & Mary Beth Molnar
Donald Morrow & Judy Johnson
Manouch & Sophie Moshayed
Gregg & Robin Moss
Patrick & Michelle Murphy
Mike & Karen Murtaugh
Barry & Suzanne Mycorn
Jay & Valerie Myers
Lonnie & Marie Nadal
George Naidus
Peter & Jane Nelson
Tim & Van-Anh Ngo
Vu & Christina Nguyen
Brad & Amy Noe
Thomas Noto & Rosemary Healy
Michael & Debra Ogorek
Fred Page & Floy Andrews
Jay & Marijane Palchikoff
Jim & Lynn Patricola
Jim & Kim Pawell
Ron & Tara Perkins
Thanh Pham
Marianne Pick
Edward & Nancy Pollard
Bill & Meg Powers
Paul & Michelle Prescott
David & Kim Prickett
Kevin & Rhonda Priestley
Jacob & Gina Rabinovich
Peggy & Gary Ramillon/Grosslight
Ed & Sandra Rempalski
Thomas & Michelle Rhodes
Paul & Susan Riddles
Kevin & Nancy Roberts
Tom & Carrie Rolfes
Stephen & Karen Roney
David & Desiree Rossi
Georges Roudanez
Bob & Betsy Rovzar
Lloyd & Jami Rucker
Ron & Tamie Rus
Jeff & Lockie Russell
Dennis & Roslyn Rustigan
Ron & Mary Sadler
David Salisbury
Mark & Anne Satterfield
Carsten & Michelle Schnepel

TECHNOLOGY DONORS

The CdM Foundation thanks all of the families who gave additional contributions to support CdM's Technology plan. Beginning with last spring's Neptune's Ball and over the summer, these families and businesses have **contributed over \$140,000** to our technology plan. Our goal for the 2006-07 is to **raise \$300,000** for Technology. **Thank you** to all who have kick-started our Technology fundraising efforts.

Tom & Jill Schriber
 Greg & Marianne Scott
 Daniel & Diane Seals
 Kirk Seaman & Dawni Novak
 Duane & Marsha Seely
 Kristin Mauger/Shumate
 Bob & Lauren Silvernail
 Ralph & Linda Simmonds
 Tom Smith
 Andrew Smits
 Jim & Deanna Socoloske
 Edmond & Cecilia St. Geme
 Staal Family
 Les & Sally Starnes
 Kevin & Trish Steele
 Tom & Candi Stefl
 Leigh & Lucy Steinberg
 Rick & Sherry Stinehart
 Jeff & Stacy Stone
 James & Leslie Sullivan
 Marea Suozzi
 Jules & Diane Swimmer
 Terence & Pamela Tan
 Randy & Lynn Taylor
 Gary & Marlene Tolfa
 Steve & Jenny Tomlin
 Brett Trauthen & Signe Dunn
 James & Val Treadaway
 Alan Trider
 Han Tsou & Meei Shyu
 R. Scott & Karen Tucker
 Jim & Nadine Turner
 Jack & Annie Vangrow
 Richard & Linda Varner
 Victor & Terry Vega
 Dennis & Patty Vitarelli
 John & Myuriel Von Aspen
 Paul & Stacey Von Berg
 John & Barbara Walz
 Alex & Mary Beth Waniek
 James & Kim Watson
 Watty & Kimmy Watson
 Robert Weinberger & Patrice Apodaca
 Tom & Cathy Wilder
 John & Stacy Wilkerson
 Mark & Lori Williams
 Donald & Nancy Williams
 Steve & Deborah Winning
 Cam & Suzanne Woods
 David & Colleen Yasukochi
 Arne & Kathy Youngman
 Dean & Estee Zipser
 Steve Zotovich
 Mark & Jan Zucker

Corporate Sponsors & Matching Donations

AT&T
 Bloomingdale's
 Irwin Union Bank
 Pacific Life Foundation

	\$25,000	
	Spencer Croul	
	\$10,000	
Michael Bush & Kathleen Chaix	John & Janice Markley	
	\$5,000 – \$9,999	
Greg & Cindy Dillion	Ray & Liz Kennedy	Scott Mason & Karin Krogius
	\$3,500 – \$4,999	
Lennar	Jim & Kim Pawell	Arne & Kathy Youngman
Gary & Carolyn McKitterick	LBA Realty	
	\$1,001 – \$2,500	
Sean & Monica Burke	Ed & Ceci St.Geme	LPA
Dan & Dory Ford	Pat & Lisa Jones	Corrine Lyle
John & Bridget Gormly	LEXUS	Scott & Susan Riddles
	\$1,000	
Larry & Claire Bianchi	Jerry & Missy Entin	The Pierotti Family
Bruce & Diane Bearer	Chris & Malin Fletcher	David & Kim Prickett
Greg Buchert, MD & Arline Tsuchiya, MD	Doug & Julie Garn	Ed & Sandra Rempalski
Jeff & Carol Carlile	Bob & Sharon Goodmanson	Pete & Rose Reynolds
The Cassel Family	Robert & Lisa Gorab	Tom & Ginny Sands
Hugh & Rene Clary	Chip & Nancy Greene	Lou Silverman & Debbie Collins
Brian & Kate Corrigan	Kathy Hath	Brian and Kathryn Smith
Craig & Sue Cox	Jim & Merrins Jones	Joe & Peggy Stemler
Reede & Wren Dahlfors	Emory & Mary Beth Molnar	James & Kim Watson
John & Celina Doka	Don & Judy Morrow	Cam & Suzanne Woods
	\$500	
Cory & Lisa Alder	Mel & Raya Jaffee	Bruce & Denise Molnar
Charles & Lan Bolus	John & Nancy Kerr	Mark & Melinda Murtaugh
Daniel Carreras & Bridget Rielley	Michael & Sarah Larson	Reza & Neda Norouzian
Ron & Diane Dales	George & Debbie Logan	John & Barbi Townsend
Tom & Deanne Duddy	The Light Family	Mark & Lori Williams
Craig Fisher & Sharon MacDonald	Steven & Helena Melmet	
	Under \$500	
Alec & Sherry Abbott	Steve & Debbie Fink	Lloyd & Jami Rucker
Dave & Robyn Ashton	Steven & Patricia Fisher	The Steiner Family
Fal Asrani	John Giannone & Priscilla Whittington	Dennis Sundstrom & Joann Borg
Larry & Marie Atkins	Jeff & Judy Klein	The Tamiry Family
Carol Crane	Guy Olguin	Lauren Young
Mark & Jannine Eckenweiler	Nik & Doro Pakvasa	

WHERE SHOULD I PUT MY MONEY?

Simply put, we all need to support each of the three main 501(c)(3) fundraising organizations at CDM. Each organization supports a specific range of expenses at CDM. All expenses are designed to improve your child's experience at CDM, and all are necessary to provide the quality of education our children deserve.

	FUNDRAISING GOAL	REQUESTED DONATION
Foundation	\$400,000 for the annual budget	\$1,000 per year
Boosters	\$100,000 for arts, academics, activities & athletics	\$250 per student per year
PTA	\$75,000–\$100,000 from Home Tour	\$10.00 membership
Technology (payable to the Foundation)	\$300,000 for the technology plan	\$500 to \$1,000

These are substantial goals, but the CDM community has proven time and again that these goals are obtainable. The CDM families before us have enabled these organizations to make a difference at CDM and it is up to us to continue that legacy. The following describes the charters of the three main CdM fundraising organizations:

THE CDM FOUNDATION

The **CDM Foundation** seeks to create a national model of excellence in academic achievement, cultural appreciation and leadership development, preparing for the challenges of the 21st Century through a dynamic partnership with the community.

ANNUAL BUDGET: The Foundation supports far-reaching programs and personnel primarily for recurring costs that require annual funding. These programs and personnel have no other source of funding and would not exist but for the Foundation. The annual budget of the Foundation partially or completely funds the guidance counselors, the college counselor, the school nurse, teaching assistants, computer lab assistance, math clinic, science clinic, the athletic trainer, senior project coordinator, and the community service coordinator. The Foundation budget this year is based on actual fundraising for last year. Next year's budget will be based on this year's fundraising. So what is raised this year determines the programs your child will have next year.

TECHNOLOGY PLAN: In addition, the Foundation is spearheading the fundraising efforts for CdM's Technology plan, in concert with Administration, the Boosters and PTA. Implementation of the multi-year Technology Plan began summer 2006. The total cost of this year's plan is approximately \$600,000.

THE SUPER BOOSTER CLUB

The **Super Booster Club** supports **Academics, Arts, Activities, and Athletics**. Boosters accept requests for funding throughout the year based on funds donated during the current year. The average request is less than \$5,000. While the percentages distributed to each of the 4 "A"s vary from year to year, the Boosters try to set aside at least 30% of their donations for staff development and continuing education, key components of CdM's strategic plan. Generally, about 70% of the funds raised will respond to current needs such as software licenses, technology, resource materials, special assemblies, registration fees, academic enrichment and athletic support.

THE CDM PTA

The **CDM PTA**, in addition to customary PTA responsibilities, sponsors the annual CdM Home Tour. This highly attended fundraiser generates in excess of \$100,000 each year through ticket sales to the public. The PTA grants funding to a variety of programs every February, based on requests by administration and parent groups. In general, the PTA funds one-time requests and avoids ongoing multi-year funding obligations. PTA funded programs generally run in the \$5,000 to \$15,000 range and vary greatly from year to year, depending on need.

PLEASE SUPPORT THESE WORTHY ORGANIZATIONS

We will all be approached for "fair share" payments for our students' outside activities such as sports, theater arts, mock trial, etc. It is easy to see the personal benefit from donating to our own children's activities. We cannot, however, forget the most basic "fair share" payments to the Foundation, Boosters and PTA. These organizations provide funding for essential programs that benefit all CdM students. Programs that have no funding at the state or district level. Please participate in keeping CDM a top tier school and give generously to the Foundation, Boosters, and PTA.

Technology, Counseling, Academics

Technology

This summer we have met many of our strategic plan milestones, particularly in the area of technology. With generous funding from many CdM families, we are proud to bring the following 21st century tools to your students this fall:

- Tech-oriented Resource Center
- World Language Lab
- 2 wireless Internet Cafés
- New classroom technology
- Student Technology Center

While we have made great progress, we have more work to do to complete our technology plan. To finish Phase II of our plan we need to raise more funds.

Counseling & Academics

The CdM Foundation provides funding for many important staff positions and academic programs that have no other source of funding, including:

- 1.5 Counselors
- After-school math and science clinics
- Counseling technician
- Staff training retreat
- School nurse (50%)
- Teachers' assistants
- On-site computer technician
- Senior project coordinator
- Music consultants
- Community Service Coordinator stipend

We need your support to continue these vital programs. Please send in your Foundation and Technology contributions today. Together we will prepare our students for the future they deserve.

Your partners in a NEW CdM,

FAL ASRANI
CdM HS Principal

GUY OLGUIN
CdM MS Principal

BRIAN TULLEY
MS Teacher and
CdM Technology Coordinator

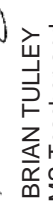

New Technology



CdM Counselors



Academic Programs

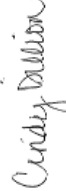

CINDY DILLON
CdM Foundation Chairman



DAN & DORY FORD
Super Boosters Co- Presidents

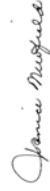

JANICE NEWFIELD
CdM HS PTA President

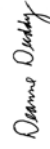

DEANNE DUDDY
Middle School PTA President

Corona del Mar Middle School & High School Foundation
1280 Bison Avenue, Suite B9-437
Newport Beach, CA 92660

PRESORTED
FIRST CLASS MAIL
U.S. POSTAGE PAID
P# 4140
SANTA ANA, CA